



WIRELESS DEPTH CALIPER IP67

USER MANUAL



Calibration ISO 17025:2017



ISO 9001:2015

Item No	Range		Reso- lution	Accu- racy	Base	Protection	Preset	WIRELESS	Display
	mm	inch							
1432010154	0-150	0-6"	0,01	±20	102	IP67	•	•	Swiss 11 mm digit
1432010204	0-200	0-8"		±30			•	•	
1432010304	0-300	0-12"		•			•		
1432010504	0-500	0-20"		±40	•		•		
1432011004	0-1000	0-40"		±50	•		•		
1432012004	0-2000	0-80"		±80	•		•		
1432013004	0-3000	0-120"		±100	•		•		

OPERATION INSTRUCTIONS

Wipe with a clean cloth, soaked in gasoline, measuring surface of the frame and gauge calipers to remove anti-corrosion oil. If necessary, open the battery cover; insert the battery (type CR2032) according to the polarity of the electrodes.

This caliper has Autoswitch on/ off function:

- move electronic module for switch on caliper
- after 10 minutes without any moving caliper will switch off

During the measurement, measuring jaws should to sum to the measured object without knocking.

During the measurement avoid warps of measuring surfaces of the instrument. Measuring surface must be fully in contact with the measurement object

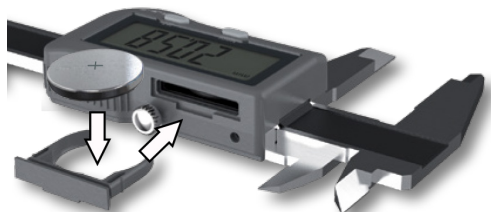

BATTERY REPLACEMENT

WARNING!

IN THE PROCESS OF WORKING WITH CALIPERS SHOULD BE AVOIDED:

Scratches on the measuring surfaces;

Measuring the size of object in the process of machining;

Shocks or dropping, avoid bending of rod or other surfaces.



BUTTON FUNCTIONS

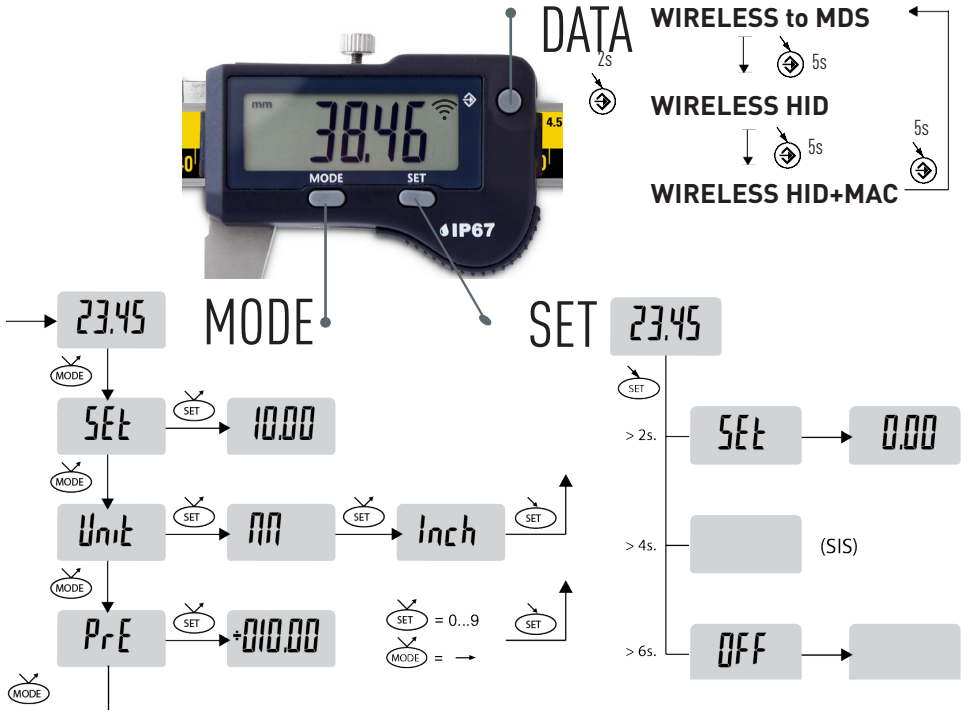

POWER CONSUMPTION

MODE		TRANSFER DATA
WIRELESS OFF		45 µA
WIRELESS TO MDS	STANDARD	2.0 mA
	ECO (GATT)	45-100 µA
WIRELESS HID		0.4 mA
WIRELESS HID+MAC		0.4 mA

MICROTECH caliper with Built-in Wireless data output module for transfer results

MODE		TRANSFER DATA	Switch ON	Switch OFF	Select MODE	DATA send
WIRELESS TO MDS	STANDARD	MICROTECH MDS app Windows, Android, iOS, MacOS	2s.	auto switch off when disconnect	STANDARD or ECO in MDS app	blinking non stop push, or on MDS app
	ECO (GATT)		all time active			no
WIRELESS HID	Direct to any customer app (like keyboard)		2s	auto switch off when disconnect or no data 10 min	5s.	blinking 2 sec push
WIRELESS HID+MAC					and connect BT on PC or Tablet	

WIRELESS DATA TRANSFER CONNECTION

SWITCH ON WIRELESS module push button 2 sec;

In **WIRELESS TO MDS** non-stop blinking on display up to connection to MDS app and selecting **STANDARD** or **ECO** sub-mode. *ECO recommended for battery economy*

In **STANDARD** submode data transfer 4 times/sec and all time on display.

Push button to save data to MDS app or use buttons and Timer inside app.

In **ECO (GATT)** submode caliper ready to transfer data any time with no indication.

Push button to save data on MDS app.

For selecting next mode push 5 sec.

WIRELESS HID and **WIRELESS HID+MAC** blinking 2 sec on display and will be ready for searching on Tablet, Smartphone or Computer Bluetooth connections.

After succesfull connection save data to customers app with push button.

DOWNLOAD MICROTECH MDS APP

Link to to Download MICROTECH MDS app for Windows, Android, iOS, MacOS on www.microtech.tools

DOWNLOAD APP



VIDEO MANUAL

Video manual with Connection on MICROTECH YouTube <https://www.youtube.com/@Microtech-Instruments> or by QR code scanning

