

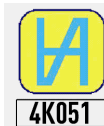

LONG JAW INTERNAL CALIPER MICROTECH IP67



ISO/IES 17025:2006 (cert. № 4K051)



Quality management system
ISO 9001:2015 (cert. № U228396)





1.MODIFICATIONS

Item No	Range		Resolution		Accuracy	Lubrication system	Waterproof	Digit height	Data output
	mm	inch	mm	inch	μm				Wireless
141130153	0-150	0-6"	0,01	0.0005"	± 30	+	IP67	11,5	-
141131154					± 30				max 30m

2.BUTTON FUNCTIONS & BATTERY REPLACEMENT



MODE SET

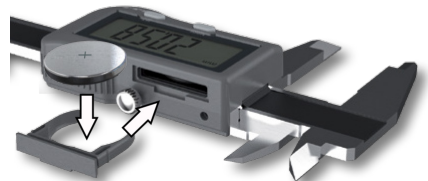

BATTERY REPLACEMENT

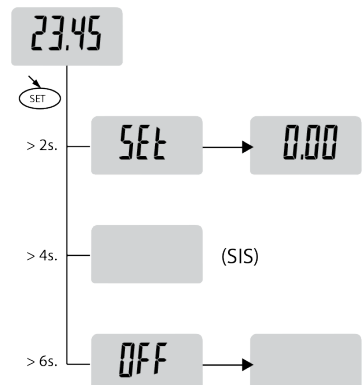
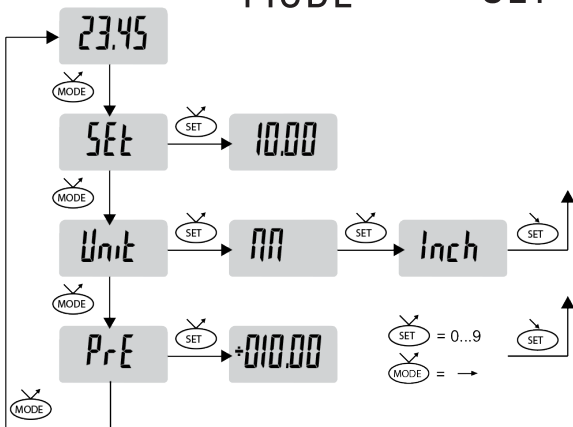



3. OPERATION INSTRUCTIONS

3.1 Wipe with a clean cloth, soaked in gasoline, measuring surface of the frame and gauge calipers to remove anti-corrosion oil. Then wipe them with a clean dry cloth.

3.2 If necessary, open the battery cover; insert the battery (type CR2032) according to the polarity of the electrodes. Blinking display information or absence suggests replacing battery.

3.3 After finishing work wipe the measuring surfaces of the caliper with a cloth soaked in gasoline and apply anticorrosion oil.



WARNING!

IN THE PROCESS OF WORKING WITH CALIPERS SHOULD BE AVOIDED:

Scratches on the measuring surfaces;

Measuring the size of object in the process of machining;

Shocks or dropping, avoid bending of rod or other surfaces.

4. DIGITAL BLOCK CHARACTERISTIC

Item No	Range
	mm
Repeatability	10 μ
Max slider speed	max 2,5 m/s
Display refresh rate	>10/s
Mean power consumpt.	45 μ A
Battery life	8000 h
IP specification	IP67 (IEC60529)





5.LUBRICATION SYSTEM

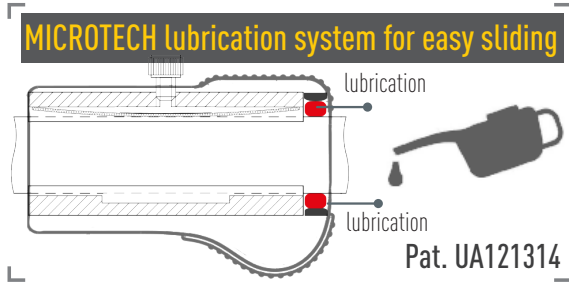

6.INSTRUMENT FIGURE

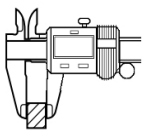

NO

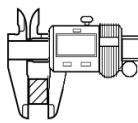

YES



NO



YES

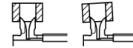

NO



YES

